

SPECIFICATION FOR APPROVAL

<p>CUSTOMER'S APPROVAL CHOP</p> <p>Approval's condition: _____</p> <p>Approved date: _____</p>
--

KINDLY RETURN A SET WITH YOUR COMPANY'S OFFICIAL
STAMP ON APPROVAL OF THIS ITEM

CUSTOMER'S NAME: _____

CUSTOMER'S MODEL NO. : _____

CUSTOMER'S PART NO. : _____

DESCRIPTION: _____ **PQ2625** _____

Semitel'S MODEL NO. : _____ **PQ2625-727** _____

VERSION: _____ **A** _____

DATE: _____ **2020/12/14** _____

- Attachments :**
- Product specification
 - Sample Qty. :
 - Test data

Prepared By	Checked By	Approved By
Hebe Deng 2020/12/14	Liang Wong 2020/12/14	Alan Wong 2020/12/14

Semitel International Ltd.,	TEL: 886-2-86922121 FAX: 886-2-26483379
www.semitelint.com	12F, No.183, Sec.1, Datong Rd., Xizhi Dist., New Taipei City 22145, Taiwan

Product Specification

1. Physical Dimensions (Unit:mm)

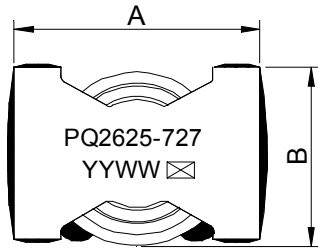

Top View

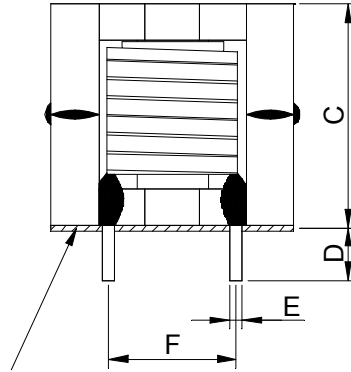

Double Conduction Insulation Tape

- A 28.0MAX.
- B 21.5MAX.
- C 26.0MAX.
- D 3.25+1.0/-0.5
- E 1.3±0.1
- F 13.0±0.5

Notes:

- (1).Marking type is laser printing
- (2).YY: Year Code; WW: Week Code
- (3). :When making samples, S is used to represent the product is a sample
- (4). :Use different letters or numbers to represent the products are produced from different production lines
- (5).Size A and B not including epoxy
- (6).Size C does not include the plastic plate of the the double conduction insulation tape
- (7).Size D not including soldering tags

2. Connection

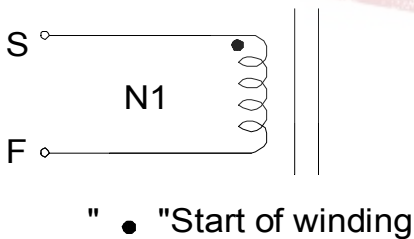

3.Recommended Pad Layout (Unit:mm)

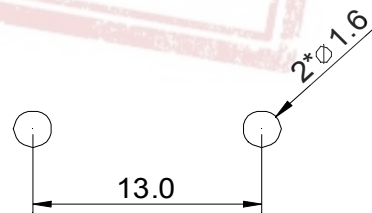

4.Structure of Products

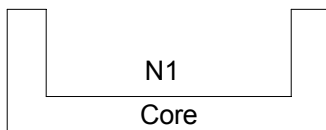

5. No of Turns & Wire Spec.

No	No of Pin	Turns	Wire Spec
N1	S -- F	20 TS	Ø1.3mm HAI/U

Semitel'S MODEL NO. :	PQ2625-727	CUSTOMER'S MODEL NO. :	
VERSION:	A	CUSTOMER'S PART NO. :	
DATE:	2020/12/14		

Product Specification

6. Electrical Characteristics

*Operating temperature range: -40°C to +125°C including temp rise.

*Storage temperature range: -40°C to +125°C .

Items	Winding	Specifications	Test Conditions
Inductance	L(S-F)	33uH±10%	at 200kHz, 1Vrms
Inductance	L(S-F)	28uH MIN.	at 200kHz, 1Vrms, @15ADC
DCR	R(S-F)	16mΩ MAX.	at 25°C

7. Bill of Material

No	Item	Material Name	Manufacturer	UL File No	SGS File No
1	Core	Ferrite core JCP40	FCRI or Equivalent	NIL	A2200234874101001R1
OR	Core	SOFT FERRITE CORE JP	CEC PANDA or Equivalent	NIL	SHAEC2007796401
2	Double Conduction Insulating TAPE	Bond Ply 100	HENKEL(Bergquist) or Equivalent	E59150	CE/2018/53058
3	Copper Wire	Polyurethane wire HAI/U	PA CIFIC or Equivalent	E201757	A220035992510303E
4	EPOXY	EB-360	CHANGFENG or Equivalent	NIL	SHAEC2022446003
5	Varnish	8562*	HANG CHEUNG or Equivalent	E200154	CANEC2000055005
6	Solder	Lead free solder	HONGTAIZHOU or Equivalent	NIL	SZXEC2001415205

Semitel'S MODEL NO. :	PQ2625-727	CUSTOMER'S MODEL NO. :	
VERSION:	A	CUSTOMER'S PART NO. :	
DATE:	2020/12/14		

Product Specification

8.Wave Solder Profile

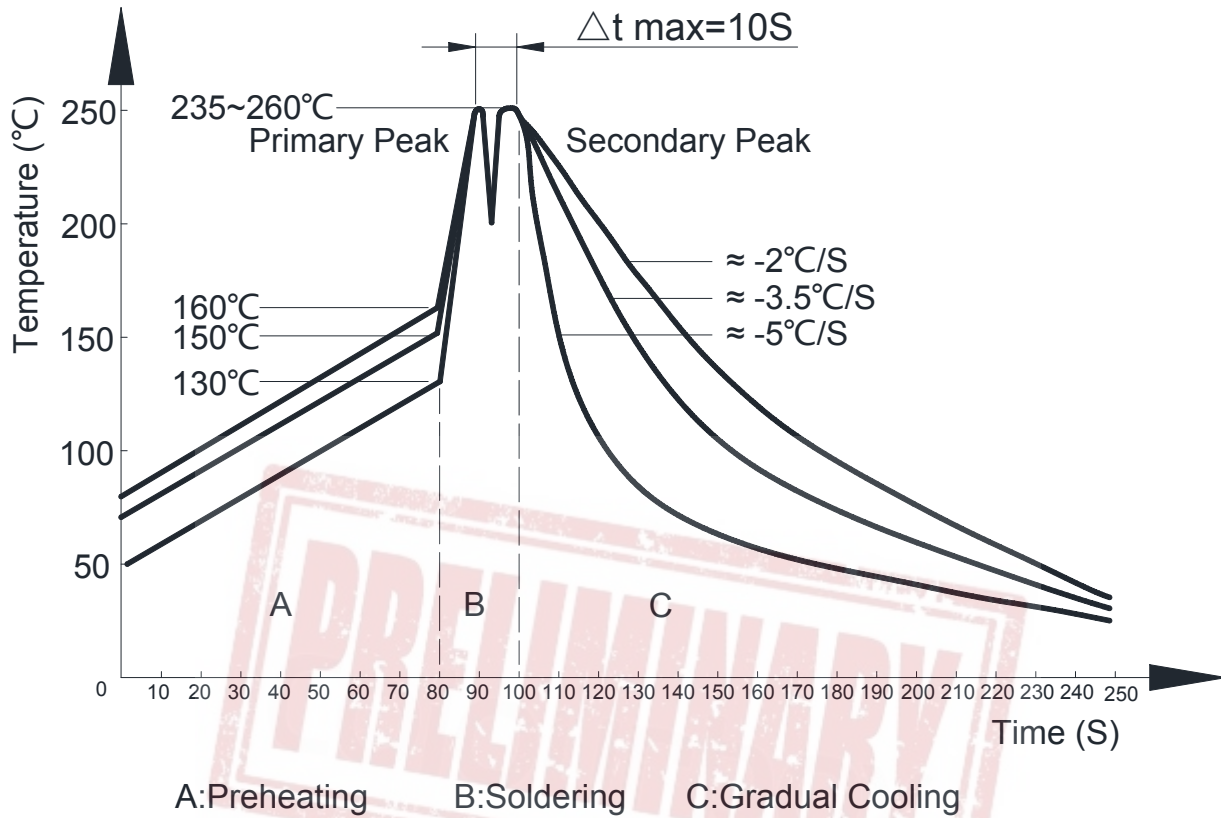

Semitel'S MODEL NO. :	PQ2625-727	CUSTOMER'S MODEL NO. :	
VERSION:	A	CUSTOMER'S PART NO. :	
DATE:	2020/12/14		

Product Specification

9.Packing Request

*Put in the EPE slot, each layer contains 60pcs products.

*Every carton box contains 300pcs products,with a total of 5 layers.

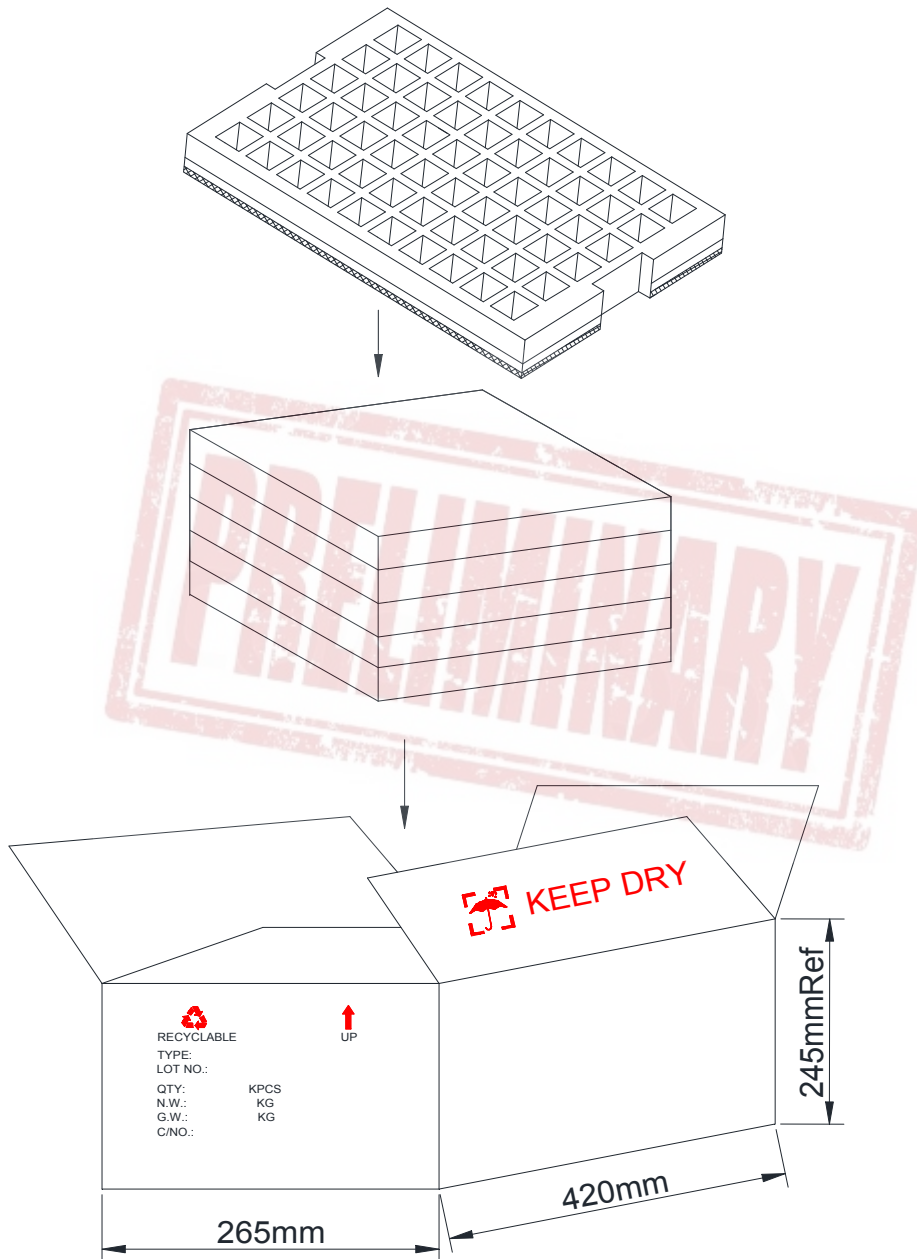

Semitel'S MODEL NO. :	PQ2625-727	CUSTOMER'S MODEL NO. :	
VERSION:	A	CUSTOMER'S PART NO. :	
DATE:	2020/12/14		

Test Report

		Test Instruments					
		HP4284A	LCR METER 1062 1720	VR131			
NO	Inductance	Inductance	DCR				
	L(S-F)	L(S-F)	R(S-F)				
	at 200kHz,1Vrms	at 200kHz,1Vrms, @15ADC	at 25°C				
	33uH±10%	28uH MIN.	16mΩ MAX.				
1							
2							
3							
4							
5							
MIN.	0.00	0.00	0.00				
MAX.	0.00	0.00	0.00				
AVG.	#DIV/0!	#DIV/0!	#DIV/0!				
Result	Passed	Passed	Passed				
Overall Dimensions Test				Measurement Tools: Caliper (Unit:mm)			
NO	A	B	C	D	E	F	
	28.0MAX.	21.5MAX.	26.0MAX.	3.25+1.0/-0.5	1.3±0.1	13.0±0.5	
1							
2							
3							
4							
5							
MIN.	0.00	0.00	0.00	0.00	0.00	0.00	
MAX.	0.00	0.00	0.00	0.00	0.00	0.00	
AVG.	#DIV/0!	#DIV/0!	#DIV/0!	#DIV/0!	#DIV/0!	#DIV/0!	
Result	Passed	Passed	Passed	Passed	Passed	Passed	

Semitel'S MODEL NO. :	PQ2625-727	CUSTOMER'S MODEL NO. :	
VERSION:	A	CUSTOMER'S PART NO. :	
DATE:	2020/12/14		