

SPECIFICATION FOR APPROVAL

CUSTOMER'S APPROVAL CHOP

Approval's condition: _____

Approved date: _____

KINDLY RETURN A SET WITH YOUR COMPANY'S OFFICIAL
STAMP ON APPROVAL OF THIS ITEM

CUSTOMER'S NAME: _____

CUSTOMER'S MODEL NO. : _____

CUSTOMER'S PART NO. : _____

DESCRIPTION: _____

ATQ27

Semitel'S MODEL NO. : _____

ATQ27-545

VERSION: _____

A

DATE: _____

2020/7/16

Attachments:

- Product Specification
- Sample Qty. :
- Test Data

Prepared By	Checked By	Approved By
Hebe Deng 2020/7/16	Liang Wong 2020/7/16	Alan Wong 2020/7/16

Semitel International Ltd.,	TEL: 886-2-86922121 FAX: 886-2-26483379
www.semitelint.com	12F, No.183, Sec.1, Datong Rd., Xizhi Dist., New Taipei City 22145, Taiwan

Product Specification

1. Physical Dimensions (Unit:mm)

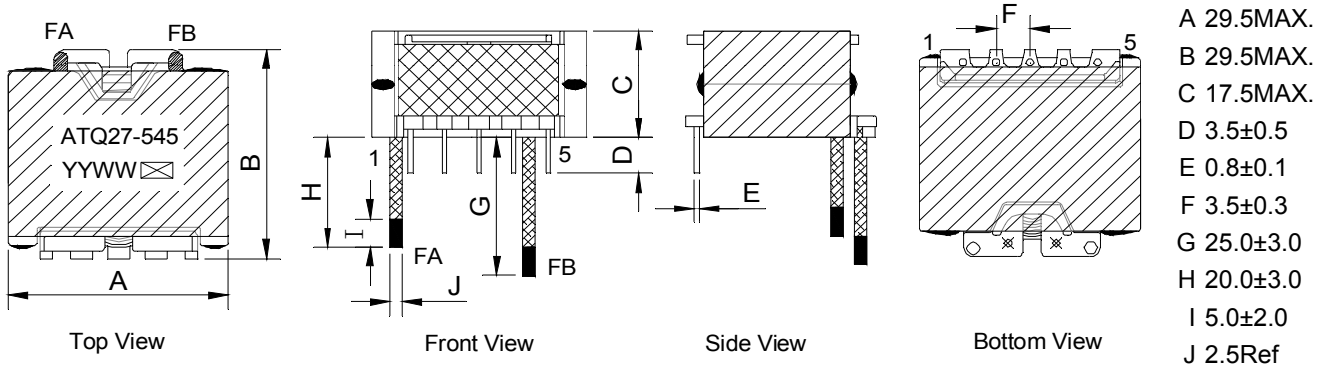

Notes:

- *Marking type is laser printing
- *YY: Year Code; WW: Week Code
- * :When making samples, S is used to represent the product is a sample
- * :Use different letters or numbers to represent the products are produced from different production lines
- *Size D not including soldering tags

2. Connection

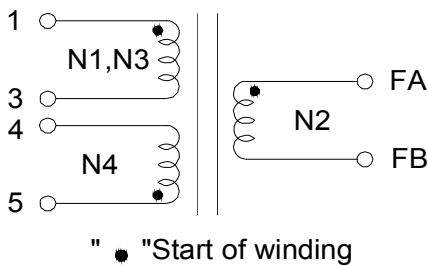

3. Recommended Pad Layout (Unit:mm)

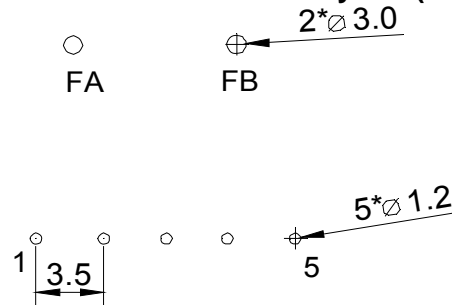

4. Structure of Products

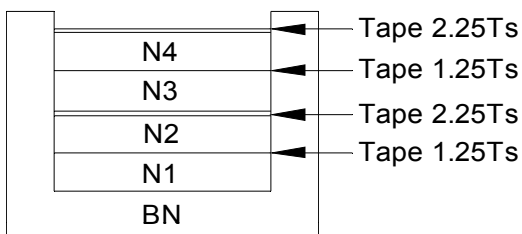

5. No of Turns & Wire Spec

No	No of Pin	Turns	Wire Spec
N1	1 - 3	8 TS	\varnothing 0.32m*2P P180
N2	FA - FB	2 TS	\varnothing 0.10m*200P P180
N3	1 - 3	8 TS	\varnothing 0.32m*2P P180
N4	5 - 4	5 TS	\varnothing 0.32m*1P P180

Semitel'S MODEL NO. :	ATQ27-545	CUSTOMER'S MODEL NO. :	
VERSION:	A	CUSTOMER'S PART NO. :	
DATE:	2020/7/16		

Product Specification

6. Electrical Characteristics

Items	Winding	Specifications	Test Conditions
Inductance	L(1-3)	300uH MIN	at 250kHz,0.1Vrms
LK-Inductance	LK(1-3) Tie other	1.5uH MAX.	at 250kHz,0.1Vrms
DCR	R(1-3)	50mΩ MAX.	at 25°C
	R(5-4)	100mΩ MAX.	
	R(FA-FB)	2.5mΩ MAX.	
Turns Ratio	(1-3):(5-4):(FA-FB)	8:5:2;±3%	at 100kHz,0.1Vrms
Hi-Pot	Pri. to Sec.	1500VAC	5mA,3Sec
	Win. to Core	500VAC	

7. Bill of Material

No	Items	Material Name	Manufacturer	UL File No	SGS File No
1	Core	FERRITE CORE NH9	LIANFENG or Equivalent	N/A	A2190208446101001
2	Bobbin	PHENOLIC T375J	CHANG CHUN or Equivalent	E59481	CE/2019/C0144
3	Copper Wire	Polyurethane bare wire (Cu) Polysol 180	ELEKTRISOLA or Equivalent	E258243	CE/2020/34972
OR	Copper Wire	Polyurethane wire UEWH/U,	PACIFIC or Equivalent	E201757	A219029024010101E
4	Polyimide Tape	Brown adhesive plastic HN NC 0.025mm V-0	RUNSEA (RAYITEK) or Equivalent	E339977	SZXEC2000536905
5	Varnish	8562*	HANG CHEUNG or Equivalent	E200154	CANEC2000055005
6	Epoxy	EB-360	CHANGFENG or Equivalent	N/A	SHAEC1925290501
7	Epoxy	TH320	TIAN HUAN or Equivalent	E257593	SZXEC1902353001
8	Solder	Lead-free solder bar	HONGTAIZHOU or Equivalent	N/A	SZXEC2001415205

Semitel'S MODEL NO. :	ATQ27-545	CUSTOMER'S MODEL NO. :	
VERSION:	A	CUSTOMER'S PART NO. :	
DATE:	2020/7/16		

Product Specification

8.Wave Solder Profile

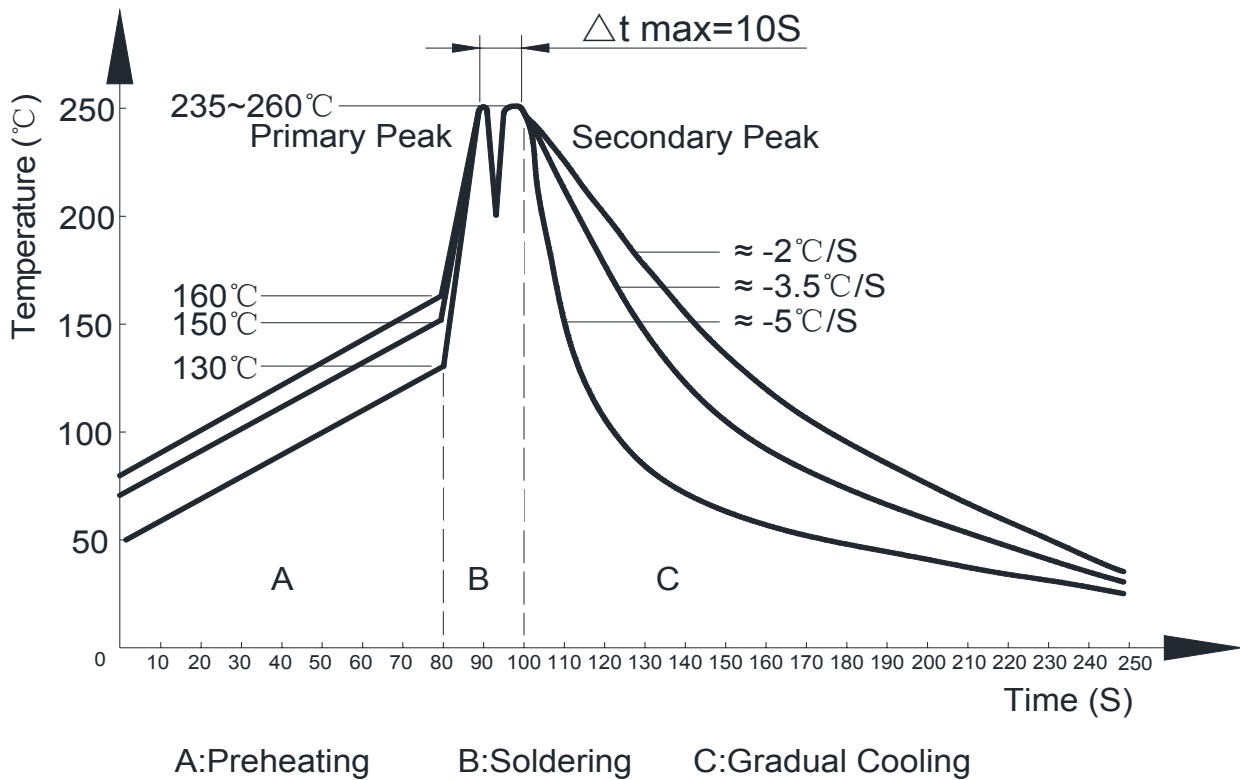

Semitel'S MODEL NO. :	ATQ27-545	CUSTOMER'S MODEL NO. :	
VERSION:	A	CUSTOMER'S PART NO. :	
DATE:	2020/7/16		

Test Report

Test Instruments									
	HP4284A	HP4284A	VR131				CS2670A		
NO	Inductance	LK-Inductance	DCR				Hi-Pot		
	at 250kHz,0.1Vrms	at 250kHz,0.1Vrms	at 25°C				5mA,3Sec		
	L(1-3)	LK(1-3) Tie other	R(1-3)	R(5-4)	R(FA-FB)		Pri. to Sec.	Win. to Core	
	300uH MIN	1.5uH MAX.	50mΩ MAX.	100mΩ MAX.	2.5mΩ MAX.		1500VAC	500VAC	
1	450.00	1.20	35.00	80.00	1.50		Passed	Passed	
2									
3									
4									
5									
MIN.	450.00	1.20	35.00	80.00	1.50				
MAX.	450.00	1.20	35.00	80.00	1.50				
AVG.	450.00	1.20	35.00	80.00	1.50				
Result	Passed	Passed	Passed	Passed	Passed		Passed	Passed	
Overall Dimensions Test					Measurement Tools: Caliper (Unit:mm)				
NO	A	B	C	D	E	F	G	H	I
	29.5MAX.	29.5MAX.	17.5MAX.	3.5±0.5	0.8±0.1	25.0±3.0	20.0±3.0	5.0±2.0	2.5Ref
1									
2									
3									
4									
5									
MIN.	0.00	0.00	0.00	0.00	0.00	0.00	0.00	0.00	0.00
MAX.	0.00	0.00	0.00	0.00	0.00	0.00	0.00	0.00	0.00
AVG.	#DIV/0!	#DIV/0!	#DIV/0!	#DIV/0!	#DIV/0!	#DIV/0!	#DIV/0!	#DIV/0!	#DIV/0!
Result	Passed	Passed	Passed	Passed	Passed	Passed	Passed	Passed	Passed

Semitel'S MODEL NO. :	ATQ27-545	CUSTOMER'S MODEL NO. :	
VERSION:	A	CUSTOMER'S PART NO. :	
DATE:	2020/7/16		